

# MULTI-PURPOSE LID (W/DAMPER)

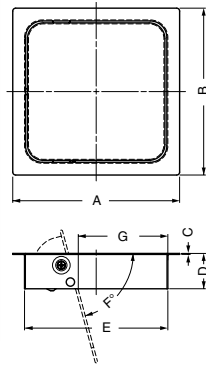

**AD-KH**



- Features damper to keep lid from slamming shut.
- Made of stainless steel for corrosion resistance.
- Wide opening.
- Balance weight restores lid to horizontal position.
- Operating temperature: 32°F - 104°F (0°C - 40°C).

6-11/16" (170 mm)



AD-KH015-HL

8-11/16" (220 mm)



AD-KH020-HL

11-13/16" (300 mm)

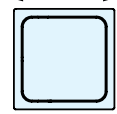

AD-KH028-HL

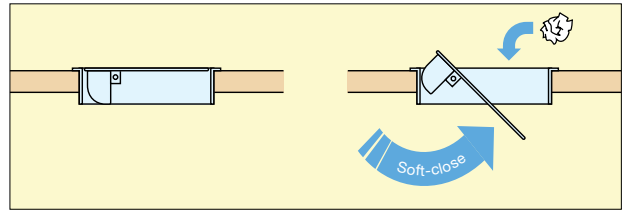
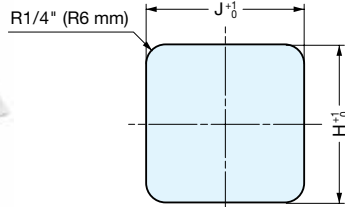

Item No.	Material	Finish	A	B	C	D	E	F	G	H	J	Weight (g)
AD-KH015-HL	304 Stainless Steel	Satin	6-11/16" (170 mm)	6-11/16" (170 mm)	1/16" (1.2 mm)	1-7/16" (36 mm)	5-3/4" (146 mm)	80°	3-11/16" (93 mm)	5-13/16" (147 mm)	5-13/16" (147 mm)	970
AD-KH020-HL			8-11/16" (220 mm)	8-11/16" (220 mm)	1/16" (1.2 mm)	2" (50 mm)	7-3/4" (196 mm)	77°	5" (127 mm)	7-3/4" (197 mm)	7-3/4" (197 mm)	1400
AD-KH028-HL			11-13/16" (300 mm)	11-13/16" (300 mm)	1/16" (1.2 mm)	2-13/16" (72 mm)	10-7/8" (276 mm)	80°	7-1/2" (191 mm)	10-15/16" (277 mm)	10-15/16" (277 mm)	2700

# MULTI-PURPOSE GROMMET



**AN-KH**

- Corrosion resistant.
- Ideal for small dustbin applications.

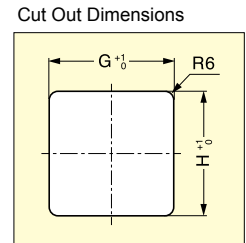
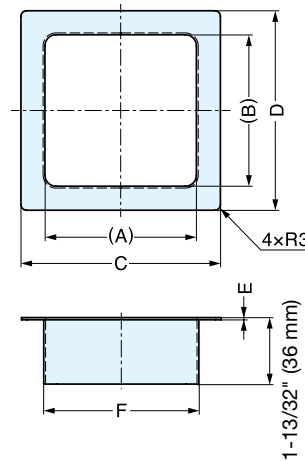

Material	Finish
304 Stainless Steel	Satin

Item No.	Old Item No.	A	B	C	D	E	F	G	H	Weight (g)	Box (pcs)	Carton (pcs)
AN-KH005-HL	-	2-3/16" (56 mm)	2-3/16" (56 mm)	3-1/4" (82 mm)	3-1/4" (82 mm)	1/16" (1.2 mm)	2-1/4" (58 mm)	2-5/16" (59 mm)	2-5/16" (59 mm)	87	1	150
AN-KH008-HL	AN-KH001	3-1/4" (82 mm)	3-1/4" (82 mm)	4-1/4" (108 mm)	4-1/4" (108 mm)		3-5/16" (84 mm)	3-3/8" (85 mm)	3-3/8" (85 mm)	126		10
AN-KH015-HL	AN-KH017	5-11/16" (144 mm)	5-11/16" (144 mm)	6-11/16" (170 mm)	6-11/16" (170 mm)		5-3/4" (146 mm)	5-13/16" (147 mm)	5-13/16" (147 mm)	217		