

BODY COVERS Hides screws for a sleek look

360HC-19H26-NI

3/4" and 1" (19 and 26 mm OVERLAY)



- Available Hinge
360: 3/4" (19 mm overlay type)
H360: 1" (26 mm overlay type)

360HC-9H16-NI

3/8" and 5/8" (9 and 16 mm OVERLAY)



- Available Hinge
360: 3/8" (9 mm overlay type)
H360 5/8" (16 mm overlay type)

360HC-0H0-NI

(INSET)



- Available Hinge
360 (inset type)
H360 (inset type)

Item No.	Material	Finish	Weight (g)
360HC-19H26-NI	Steel	Nickel Plating	2.6
360HC-9H16-NI			2.2
360HC-0H0-NI			2.7

HINGE SPACERS

360-DP2-P4 1/16" (2 mm) Thick for 2 Holes / OLYMPIA Series



How to Use

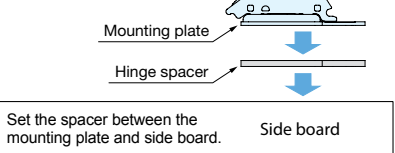

- Decreases overlay of outset doors by 1/16" (2 mm).
- Increases clearance of inset doors by 1/16" (2 mm).
- Can be doubled for 3/16" (4 mm) thickness.
- Available Mounting Plate:
360-P4W-30T
360-P4W-30T+5
360-P4W-32T
360-P4W-32T+5

Item Name	Material	Color	Weight (g)	Box (pcs)	Carton (pcs)
360-DP2-P4	POM	Grey	2.6	50	500

360-DP2-P6 1/16" (2 mm) Thick for 4 Holes / OLYMPIA Series



How to Use

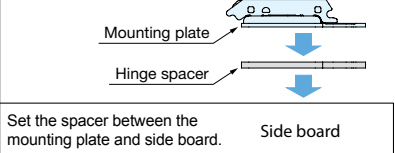

- Decreases overlay of outset doors by 1/16" (2 mm).
- Increases clearance of inset doors by 1/16" (2 mm).
- Can be doubled for 3/16" (4 mm) thickness.
- Available Mounting Plate:
360-P6WT
360-P6WT+5

Item No	Material	Color	Weight (g)	Box (pcs)	Carton (pcs)
360-DP2-P6	POM	Grey	2.9	50	500

SHEET METAL SPACER 360-BCS



• Without the spacer

• With the spacer

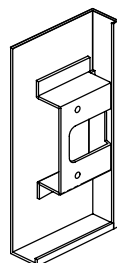
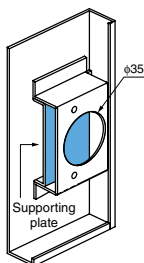

Supporting plates are required at the depth of 11 mm below the hinge cup.

No supporting plates are needed.

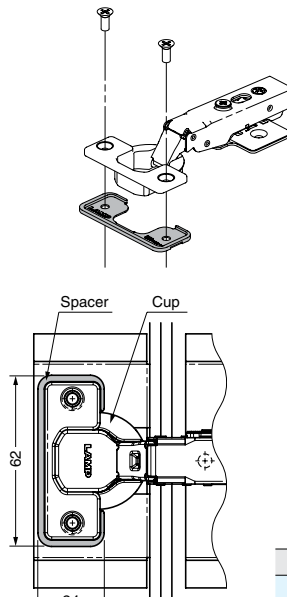

- Allows for easier mount on sheet metal of the Olympia hinges. (Cup diameter: 1-3/8" (35 mm))

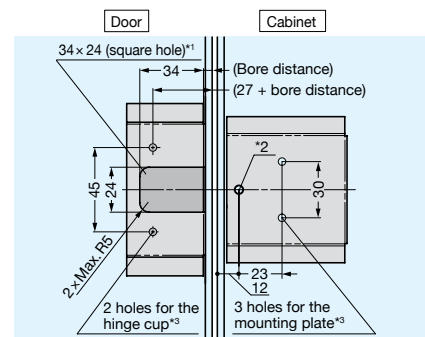

- *1: No supporting plates for hinge cups are needed.
- *2: Please process chamfering on the holes. (ø 5.1)
- *3: Female threading is required including nut welding and burring process. (Recommended size: M4)

Item No	Material	Box (pcs)
360-BCS	POM	500