

# STOPPER

# LGB30-ST

- Stopper for LGB-30CM Roller Carriage.

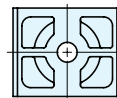
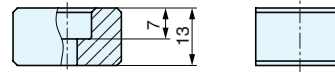
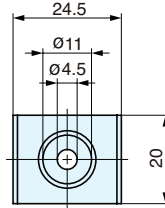

Item No.	Weight (g)	Material	Finish
LGB30-ST	5.6	Polyacetal	Black

# INSTALLATION PLATE

# LGB30-P65-100

- Installation to LGB-30CM roller carriage for any applications.



Installation with roller carriage and guide rail.

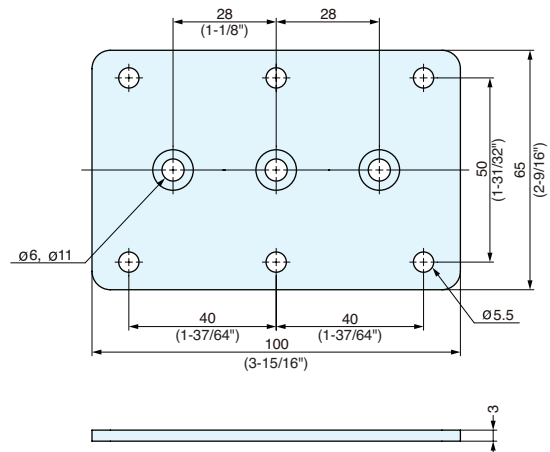

Item No.	Weight (g)	Material	Finish
LGB30-P65-100	137	304 Stainless Steel	Polished