

# DETACHABLE HINGE

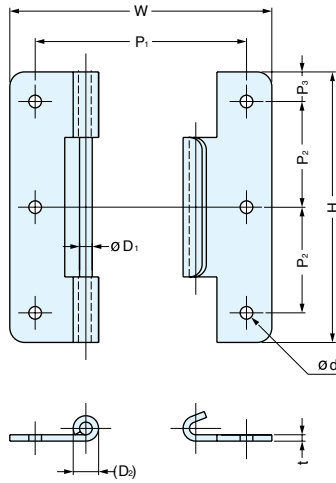

**BN**



- For use with trunk style boxes, scientific equipment, measuring devices, etc.
- Hinge leaves can be separated.

HINGES

DETACHABLE HINGE / LIFT-OFF HINGE

Item No.	H	W	P <sub>1</sub>	P <sub>2</sub>	P <sub>3</sub>	d	D <sub>1</sub>	D <sub>2</sub>	t	N	Weight (g)	Box (pcs)	Material	Load Capacity (kgf/2pcs)
BN-50S	50 (1-31/32")	30 (1-3/16")	20 (25/32")	20	5	3	3	6	1.5	6	6	200	304 Stainless Steel	12 (26.4 lbs)
BN-64S	64 (2-33/64")	36 (1-27/64")	24 (15/16")	25	7						8	150		9 (19.8 lbs)

# LIFT-OFF HINGE



**SKH**

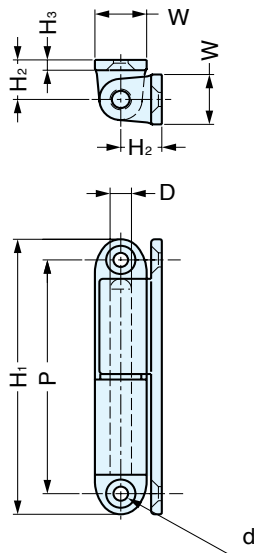

- Non Handed: can be installed on left or right side.

Item No.	H <sub>1</sub>	H <sub>2</sub>	H <sub>3</sub>	W	P	D	d	Weight (g)	Box (pcs)	Material	Load Capacity (kgf/2pcs)
SKH-51S	51 (2-1/64")	8.0	2.5	11.0 (7/16")	40 (1-37/64")	4	M3	30	30	304 Stainless Steel	8 (17.6 lbs)
SKH-60S	60 (2-23/64")	9.5	3.0	13.0 (33/64")	48 (1-57/64")	5	M4	50	30		12 (26.4 lbs)
SKH-80S	80 (3-5/32")	11.5	14.5	14.5 (37/64")	68 (2-43/64")	6		95	20		29 (63.8 lbs)