

Zwei L Knob



ZL-1906



- For use with wood or tempered glass.
- Non-handed.
- Anti-rotation pin is removable.
- Includes stainless steel screws.

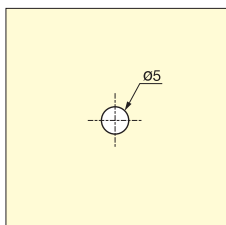
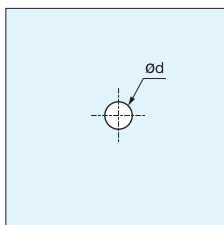

Glass Thickness:
4 or 5 mm, d = 5
6 mm, d = 6

Wood Panel

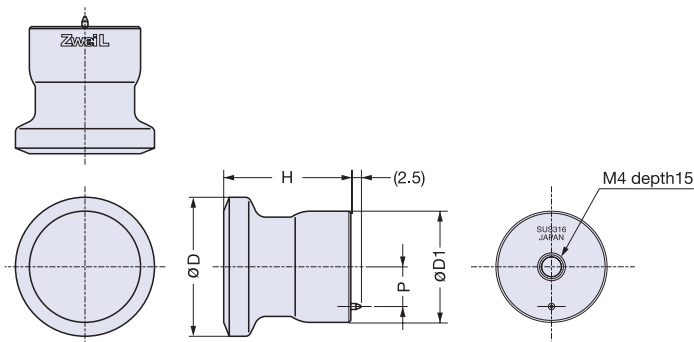

| Item No. | Material | Finish/Color | H | D | D ₁ | P | Weight (g) | Box (pcs) |
|------------|---------------------|--------------|--------------|---------------|----------------|----|------------|-----------|
| ZL-1906-20 | 316 Stainless Steel | Zwei L | 20 (25/32") | 20 (25/32") | 16.0 | 5 | 32 | 1 |
| ZL-1906-28 | | | 26 (1-1/32") | 28 (1-3/32") | 22.5 | 8 | 83 | |
| ZL-1906-36 | | | 32 (1-1/4") | 36 (1-13/32") | 28.0 | 10 | 165 | |

Zwei L Knob



ZL-1909

- For use with wood or tempered glass.
- Non-handed.
- Anti-rotation pin is removable.
- Includes stainless steel screws.

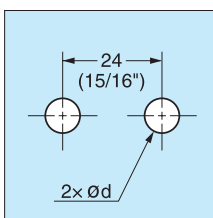
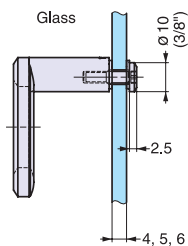

Glass Thickness:
4 or 5 mm, d = 5
6 mm, d = 6

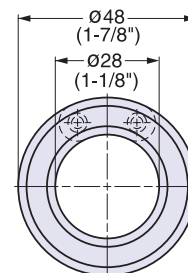
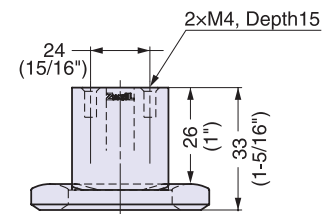
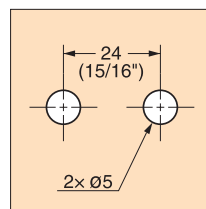
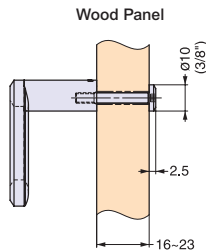

| Item No. | Material | Finish/Color | Weight (g) | Box (pcs) |
|----------|---------------------|--------------|------------|-----------|
| ZL-1909 | 316 Stainless Steel | Zwei L | 97 | 1 |