

RECESSED PULL

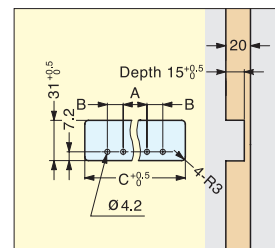

XLA-HHA

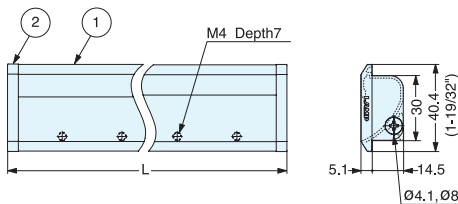

- Lightweight design.
- Bracket for sheet metal available.
Item No.: XLA-HHA40B (sold separately)

Item No.	L	A	B	C	Weight (g)	Box (pcs)	Carton (pcs)
XLA-HHA300	300 (11-13/16")	100	50	296	140	10	100
XLA-HHA600	600 (23-5/8")	200	150	596	247	5	50

No.	Material	Finish
①	Aluminum	Anodized
②	Zinc Alloy	Chrome

RECESSED PULL (BACK MOUNT)



HH-PS99

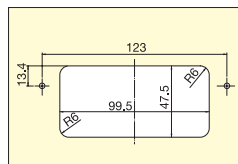

Bore Dimensions

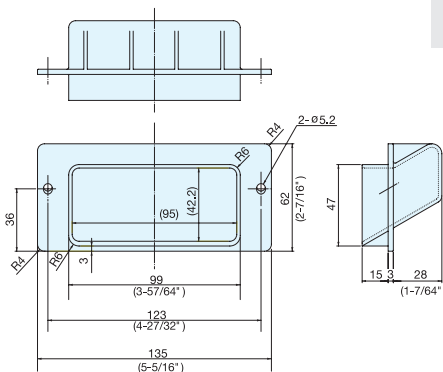

- Designed for back mount.
- Large grip space for heavy Cabinets etc.
- For panel thickness 15 mm. (19/32")

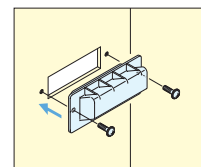
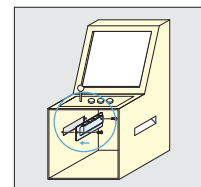

Item No.	Weight (g)	Box (pcs)	Carton (pcs)
HH-PS99	42	50	200

Material	Color
Polypropylene with Glass Fiber	Black

RECESSED PULL

UP-600

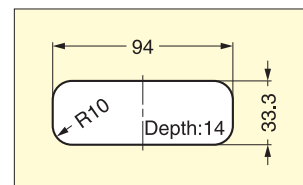
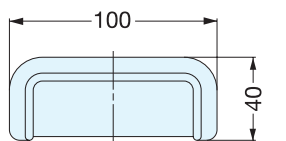

Cut out Dimensions

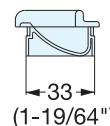
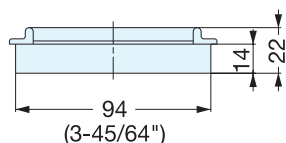

Item No.	Weight (g)	Box	Carton (pcs)
UP-600	25	50	300

Material	Color
ABS	Black, Chrome