

STAINLESS STEEL LEVELLING GLIDE

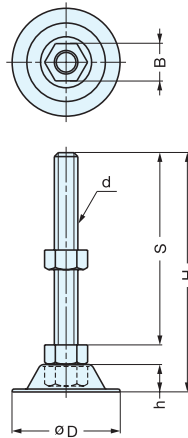

ADPS



• Nut on bottom of glide allows easy installation and height adjustment with socket wrench.

Material	Finish
304 Stainless Steel	Polished

Item No.	D	H	h	S	B	d	Load Capacity (kg)	Weight (g)	Box (pcs)	Carton (pcs)
ADPS37- 8- 60	37 (1-26/64")	76 (3")	10.5	60	13	M 8 x 1.25	300 (660 lbs)	56	200	2000
ADPS37-10- 50	37 (1-26/64")	67.5 (2-21/32")	10.5	50	17	M10 x 1.5	300 (660 lbs)	78	200	2000
ADPS55-12-100	55 (2-5/32")	122 (4-13/16")	14.0	100	19	M12 x 1.75	300 (660 lbs)	174	100	1000
ADPS55-12-120	55 (2-5/32")	142 (5-19/32")	14.0	120	19	M12 x 1.75	300 (660 lbs)	187	80	800
ADPS55-12-150	55 (2-5/32")	172 (6-25/32")	14.0	150	19	M12 x 1.75	300 (660 lbs)	210	70	700
ADPS75-16-100	75 (2-61/64")	128 (5-1/32")	18.0	100	24	M16 x 2.0	560 (1233 lbs)	318	50	500
ADPS75-16-130	75 (2-61/64")	158 (6-7/32")	18.0	130	24	M16 x 2.0	560 (1233 lbs)	358	40	400
ADPS75-16-150	75 (2-61/64")	178 (7")	18.0	150	24	M16 x 2.0	560 (1233 lbs)	382	30	300
ADPS75-16-180	75 (2-61/64")	208 (8-3/16")	18.0	180	24	M16 x 2.0	560 (1233 lbs)	426	30	300
ADPS75-20-100	75 (2-61/64")	131 (5-5/32")	18.0	100	30	M20 x 2.5	880 (1938 lbs)	490	40	400
ADPS75-20-130	75 (2-61/64")	161 (6-11/32")	18.0	130	30	M20 x 2.5	880 (1938 lbs)	553	30	300
ADPS75-20-150	75 (2-61/64")	181 (7-1/8")	18.0	150	30	M20 x 2.5	880 (1938 lbs)	593	30	300
ADPS75-20-180	75 (2-61/64")	211 (8-5/16")	18.0	180	30	M20 x 2.5	880 (1938 lbs)	655	25	250

STAINLESS STEEL LEVELLING GLIDE



ADCS

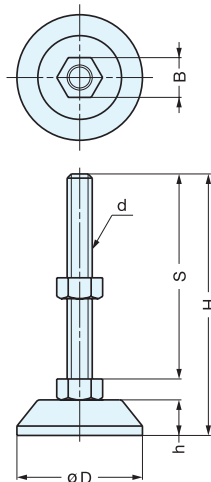

• Nut on bottom of glide allows easy installation and height adjustment with socket wrench.

Material	Finish
304 Stainless Steel	Plain

Item No.	D	H	h	S	B	d	Load Capacity (kg)	Weight (g)	Box (pcs)	Carton (pcs)
ADCS60-12-120	60 (2-23/64")	145 (5-45/64")	17	120	19	M12 x 1.75	300 (660 lbs)	365	35	350
ADCS60-16-100	60 (2-23/64")	127 (5")	17	100	24	M16 x 2.0	560 (1233 lbs)	440	25	250
ADCS60-16-130	60 (2-23/64")	157 (6-3/16")	17	130	24	M16 x 2.0	560 (1233 lbs)	480	25	250
ADCS60-16-180	60 (2-23/64")	207 (8-5/32")	17	180	24	M16 x 2.0	560 (1233 lbs)	550	20	200
ADCS60-20-100	60 (2-23/64")	130 (5-1/8")	17	100	30	M20 x 2.5	880 (1938 lbs)	590	20	200
ADCS60-20-130	60 (2-23/64")	160 (6-19/64")	17	130	30	M20 x 2.5	880 (1938 lbs)	650	20	200
ADCS60-20-150	60 (2-23/64")	180 (7-3/32")	17	150	30	M20 x 2.5	880 (1938 lbs)	690	35	350
ADCS60-20-180	60 (2-23/64")	210 (8-17/64")	17	180	30	M20 x 2.5	880 (1938 lbs)	750	15	150

DISCONTINUED