

# WIRE PULL

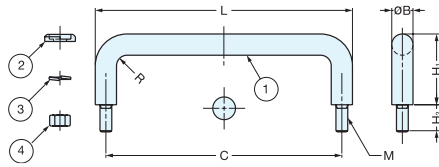

# H-42-B



No.	Part Name	Material	Finish
①	Handle	304 Stainless Steel	Mirror
②	Washer		Polished
③	Spring Washer		Plain
④	Nut		

Item No.	L	H <sub>1</sub>	H <sub>2</sub>	B	C	R	M	Weight (g)	Box (pcs)	Carton (pcs)
H-42-B-9	46	22 ( 55/46" )	8.5	6	40 ( 1-37/64" )	-	M4 × 0.70	15	50	500
H-42-B-8	66		7.0		60 ( 2-23/64" )	3.0		20		
H-42-B-14	86	30 ( 1-3/16" )	10.0	7	80 ( 3-5/32" )	3.5	M5 × 0.80	27	50	250
H-42-B-1	75		7		68 ( 2-43/64" )			4.5		
H-42-B-2	109	40 ( 1-37/64" )	11.0	9	100 ( 3-15/16" )	5.0	M6 × 1.00	80	30	150
H-42-B-3	120				10			110 ( 4-21/64" )		
H-42-B-4	130	50 ( 1-31/32" )	20.0	12	120 ( 4-23/32" )	6.0	M8 × 1.25	235	20	60
H-42-B-15	162				150 ( 5-29/32" )			6.0		
H-42-B-5	200	50 ( 1-31/32" )	20.0	12	188 ( 7-13/32" )	6.0	M8 × 1.25	320	40	40
H-42-B-6	250				238 ( 9-3/8" )			365		
H-42-B-7	300				288 ( 11-11/32" )					

# WIRE PULL



# H-42-C

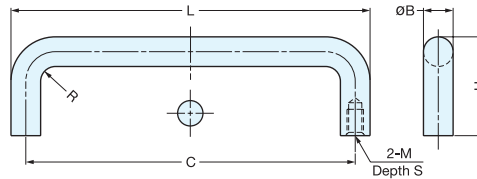

Material	Finish
304 Stainless Steel	Mirror

Item No.	L	H	B	C	S	M	R	Weight (g)	Box (pcs)	Carton (pcs)
H-42-C-8	66	22 ( 55/46" )	6	60 ( 2-23/64" )	7	M4 × 0.70	3.0	18	100	500
H-42-C-14	86			80 ( 3-5/32" )				25		
H-42-C-1	75	30 ( 1-3/16" )	7	68 ( 2-43/64" )	8	M5 × 0.80	3.5	30	50	250
H-42-C-2	109			9				100 ( 3-15/16" )		
H-42-C-3	120	40 ( 1-37/64" )	10	110 ( 4-21/64" )	8	M6 × 1.00	5.0	100	30	150
H-42-C-4	130			120 ( 4-23/32" )				105		
H-42-C-15	162	50 ( 1-31/32" )	12	150 ( 5-29/32" )	10	M8 × 1.25	6.0	185	20	60
H-42-C-5	200			188 ( 7-13/32" )				220		
H-42-C-6	250	50 ( 1-31/32" )	12	238 ( 9-3/8" )	10	M8 × 1.25	6.0	265	40	40
H-42-C-7	300			288 ( 11-11/32" )				300		

# WIRE PULL



# H-42-F14

• Ideal for high corrosive environments.

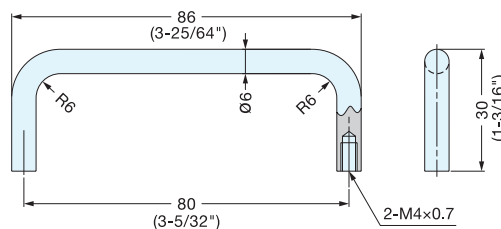

Item No.	Weight (g)	Box (pcs)	Carton (pcs)	Material	Finish
H-42-F14	25	50	250	316 Stainless Steel	Mirror