

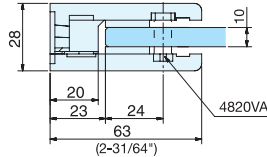

GLASS CLAMP

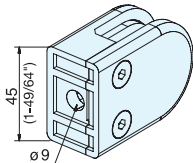

9303VA2



- 316 stainless steel clamp.
- For flat surface.
- Optional Parts: 4820VA (Safety Pin)
- See page 466 for load capacity.
- Tempered Glass Recommended.

Item No.	Glass Thickness (mm)	Weight (g)	Box (pcs)	Carton (pcs)	Material	Finish
9303VA2	10	324	10	100	316 Stainless Steel	Satin



GLASS CLAMP



9344VA2

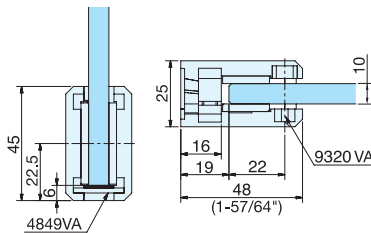
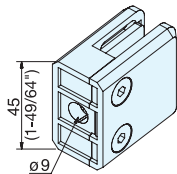

- 316 stainless steel clamp.
- For flat surface.
- Optional Parts: 9320VA (Safety Pin)
4849VA (Safety Plate)
- See page 466 for load capacity.
- Tempered Glass Recommended.

Item No.	Glass Thickness (mm)	Weight (g)	Box (pcs)	Carton (pcs)	Material	Finish
9344VA2	10	229	10	100	316 Stainless Steel	Satin