



# OV

## SOFT CLOSING MECHANISM FOR OVER-THE-TOP FLIPPER DOORS

- Patented Lapcon technology offers smooth and quiet motions.
  - Doors will not slam shut.
  - Adjustable closing speed.
  - Successfully passed 30,000 open/close private cycle tests.
- Designed to operate at room temperature 0°~40°C (32°~104F°).



Used in pairs



**Screws :**

Flat Head Machine Screw (M4 × 26) \*for wooden top board of 19~20 mm T - 8 pcs.  
 Binding Head Machine Screw (M4 × 8) \*for metal top board of 1.2~1.5 mm T - 8 pcs.  
 Binding Head Tapping Screws (M4 × 10) for slides.

Note : For sheet metal cabinets, if the top board is thicker than 20 mm (25/32"), longer screws are required (top board thickness plus 6 mm). When the top board is wooden, additional screws are not needed.

\*Bulk pack available.

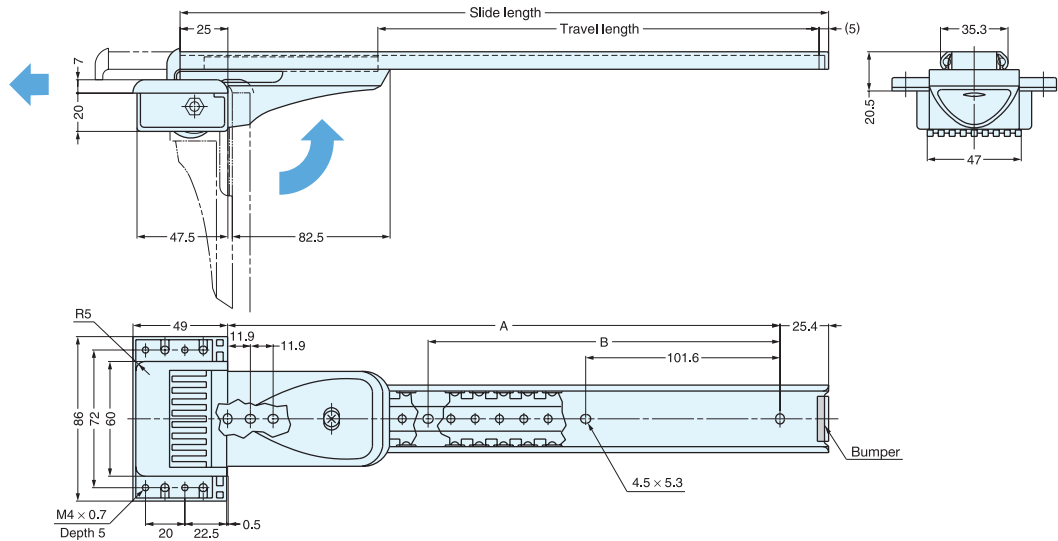

**Flipper Door Weight and Size**

Item No	Door Weight (kg)	Torque Moment (kg·cm)	Door Thickness: T (mm)	Door Width: W (mm)	Door Height: H (mm)
OV-1	3~5 (6.6~11 lbs)	60~100 (55~85 lbs-inch)	19 (3/4") or 20 (25/32")	700~1400 (27-9/16"~55-1/8")	350~450 (13-25/32"~17-23/32")

Item No.	Slide Length	Travel Length	A	B	Weight (g)	Box (pcs)	Carton (pcs)
OV-1-13	330.2	223.8	279.4	177.8	590	10	100
OV-1-14	355.6	249.2	304.8	203.2	610		
OV-1-15	381.0	274.6	330.2	228.6	630		
OV-1-16	406.4	300.0	355.6	254.0	650		

Material	Finish/Color
Steel, Zinc Alloy, Plastic	Chromate, Black

# SOFT CLOSING MECHANISM



OV

LID SUPPORTS

SOFT CLOSING MECHANISM FOR OVER-THE-TOP FLIPPER DOORS

## ■ Cabinet Preparation

### Cabinet Dimensions

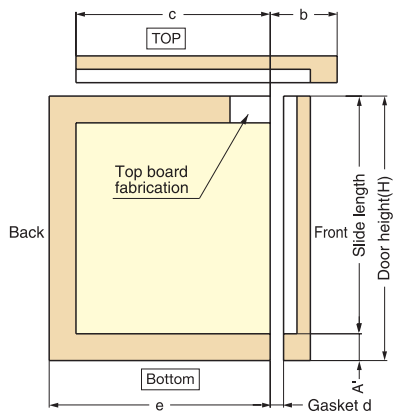

### Door Fabrication

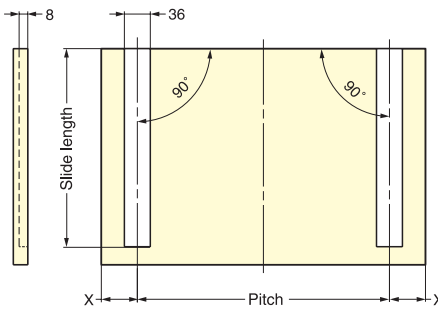

### Top Panel Fabrication

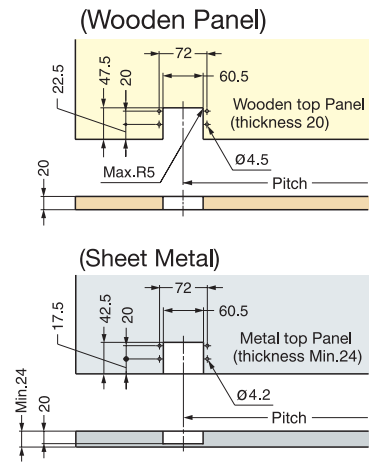

	b	c	d	e	X
Wooden Top Panel	A'+81.4	H-b	2.5	Min. c+7	Inset Application 80
Metal Top Panel	A'+86.4	H-b	7.5	Min. c+7	Overlay Application Side Board Thickness+80

## ■ Installation

