

HANDLE

STAINLESS
304
STEEL

DSI-1630

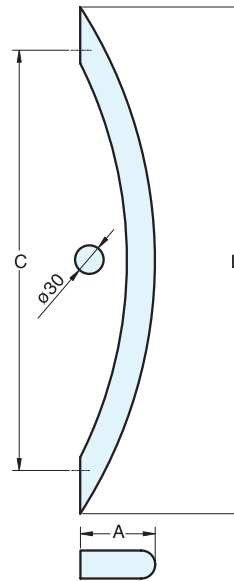

Please specify Interior/Exterior and mounting kit when ordering.
 Exterior handle-Threaded to accept M8 screw.
 Interior handle-Bare hole with set screw.

Material	Finish
304 Stainless Steel	Satin

Item No.		L	C	A	Weight (kg)	Box (pcs)	Carton (pcs)
Interior	Exterior						
DSI-1630-30-25I	DSI-1630-30-25E	314 (12-3/8")	250 (9-7/8")	66 (2-19/32")	0.8 (1.8lbs)	1	10
DSI-1630-30-35I	DSI-1630-30-35E	430 (16-15/16")	350 (13-3/4")	74 (2-29/32")	1.2 (2.7lbs)		
DSI-1630-30-45I	DSI-1630-30-45E	542 (21-5/16")	450 (17-3/4")	80 (3-5/32")	1.5 (3.3lbs)		
DSI-1630-30-60I	DSI-1630-30-60E	721 (28-3/8")	600 (23-5/8")	79 (3-7/64")	1.8 (4.0lbs)		

SLIDING DOOR HANDLE

STAINLESS
304
STEEL

DSI-3250

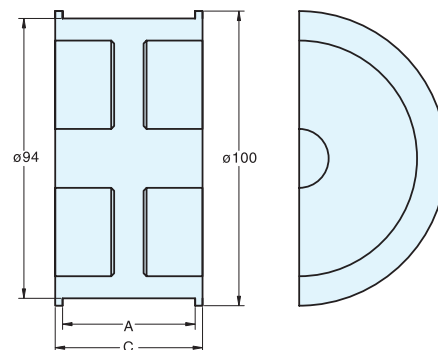

2 part epoxy adhesive required for installation. (Not supplied)

Item No.	C	A	Weight (g)	Box (pcs)	Carton (pcs)
DSI-3250-12	16 (5/8")	12 (15/32")	280 (0.6 lbs)	1	10
DSI-3250-35	39 (1-17/32")	35 (1-3/8")	440 (0.9 lbs)		
DSI-3250-45	49 (1-15/16")	45 (1-49/64")	550 (1.2 lbs)		
DSI-3250-50	54 (1-1/8")	50 (1-31/32")	670 (1.5 lbs)		

Material	Finish
304 Stainless Steel	Satin