

ANGLE BRACKET



SV-40, 55, 80



SV-55S, 80S

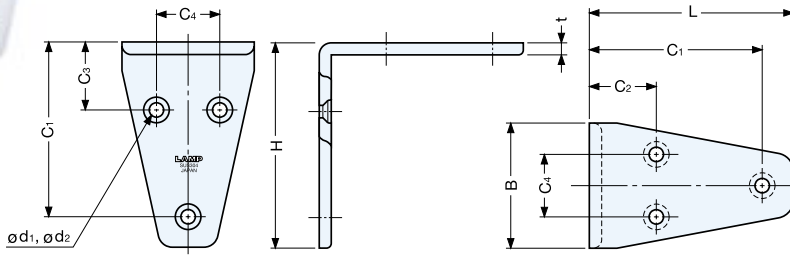

- Stainless steel angle bracket for application where corrosion is an issue.

Material	Finish
304 Stainless Steel	Mirror (M), Satin (S)

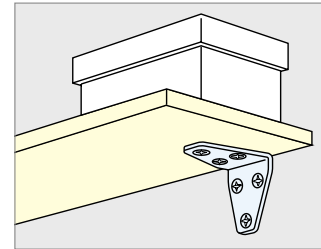

Installation

Item No.	L	H	C ₁	C ₂	C ₃	C ₄	B	t	d ₁	d ₂	Holes	Load Capacity (kg)	Weight (g)	Box (pcs)	Carton (pcs)	Screw
SV-40/M SV-40/S	40 (1-39/64")	40 (1-39/64")	34	17	17	-	25 (63/64")	3	3.3	6.5	4	8 (18 lbs)	29	40	640	3.1×20
SV-55/M SV-55/S	55 (2-13/64")	55 (2-13/64")	47	18	18	17	36.5 (1-7/16")	3	3.8	7.5	6	8 (18 lbs)	58	20	320	3.1×20
SV-80/M SV-80/S	80 (3-5/32")	80 (3-5/32")	71	24	24	27	52 (2-3/64")	4	4.3	8.5	6	14 (31 lbs)	162	10	120	3.8×20

ANGLE BRACKET



SU-30, 45, 60

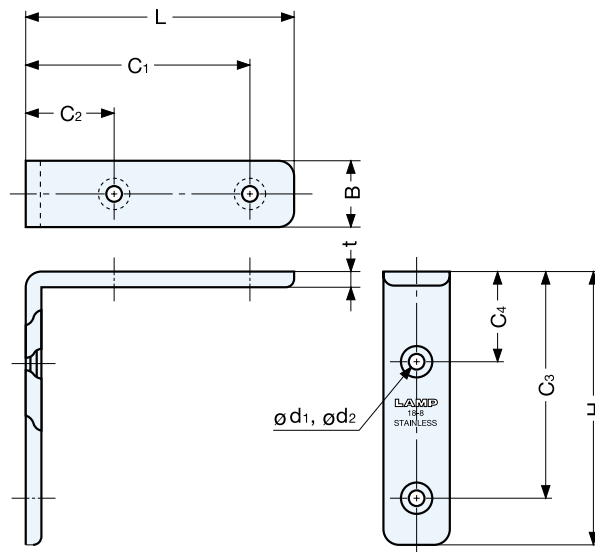
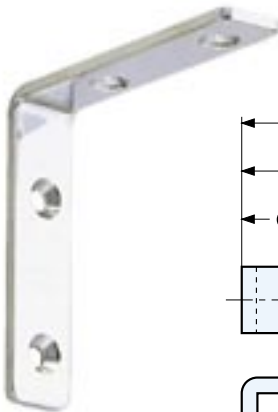

- Stainless steel angle bracket for application where corrosion is an issue.

Material	Finish
304 Stainless Steel	Mirror (M), Satin (S)

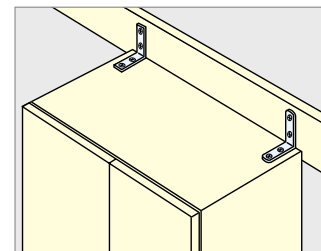

Installation

Item No.	L	H	C ₁	C ₂	C ₃	C ₄	B	t	d ₁	d ₂	Holes	Load Capacity (kg)	Weight (g)	Box (pcs)	Carton (pcs)	Screw
SU-30/M SU-30/S	30 (1-7/32")	30 (1-7/32")	24	11	24	11	12 (15/32")	2.5	3.5	6.5	4	6 (13 lbs)	11	60	960	3.1×20
SU-45/M SU-45/S	45 (1-13/16")	45 (1-13/16")	37	17	37	17	13 (33/64")	3	3.5	6.5	4	5 (11 lbs)	23	50	800	3.1×20
SU-60/M SU-60/S	60 (2-13/32")	60 (2-13/32")	50	20	50	20	15 (19/32")	3	4	7.5	4	4 (9 lbs)	36	40	640	3.5×20

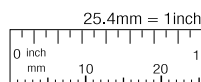

Customers outside of North America
www.sugatsune.co.jp
export@sugatsune.co.jp

North American Customers
www.sugatsune.net
 1-888-557-5267